

Nexus 110 Sounder Beacon (AC)

The Nexus 110 is a high output, sounder beacon designed for industrial applications.

Connections are made to the base during the initial wiring phase which results in faster and more reliable installation. In addition, the head is fixed by quarter turn fasteners enabling faster installation and accurate seal compression for weatherproofing.

The combination of powerful sounder and high output beacon ensures a very effective audio-visual signal.

Features

- High sound output: 116dB (max); 110dB typical
- Low voltage AC variant
- High output LED beacon
- Three alarm stages
- Quarter turn fasteners for ease of installation
- First-fix, wire to base technology
- IP66 rated
- Volume control for greater flexibility - 20dB
- 64 tones
- Separate connections for sounder & beacon

Lens Colour Options



Applications - Conveyors, Process control alarm, Cranes, Moving machinery, Safety signalling

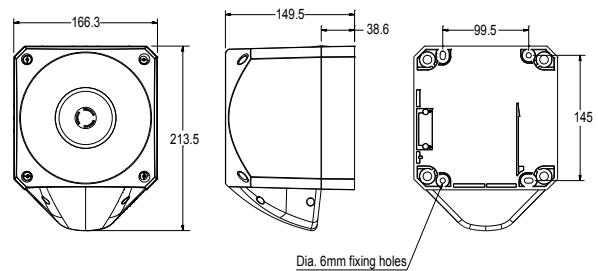

Specifications

Part No.	Lens Colour	Beacon Type	Audibility at 1m Dimensions:	Tones	Voltage	Sounder Current	Beacon Current
PNC-0221	Red Beacon	LED Beacon	116dB (A)	64	110/230V AC	40mA (max)	55mA
PNC-0222	Amber Beacon	LED Beacon	116dB (A)	64	110/230V AC	40mA (max)	55mA
PNC-0223	Clear Beacon	LED Beacon	116dB (A)	64	110/230V AC	40mA (max)	55mA
PNC-0224	Blue Beacon	LED Beacon	116dB (A)	64	110/230V AC	40mA (max)	55mA
PNC-0225	Green Beacon	LED Beacon	116dB (A)	64	110/230V AC	40mA (max)	55mA

IP Rating: IP66 Operating Temp: -25°C to +65°C Cable Entries: 5 Weight: 1.2kg

klaxon