

## Nexus 120 Sounder Beacon (DC)

The Nexus 120 is a very high output sounder beacon designed for fire and industrial applications. Connections are made to the base during the initial wiring phase which results in faster and more reliable installation.

In addition, the head is fixed by quarter turn fasteners enabling faster installation and accurate seal compression for weatherproofing. IP66 as standard means that Nexus can be installed in almost any location.

The combination of powerful sounder and high output beacon ensures a very effective audio-visual signal. 105dB and 110dB units, as well as AC variants, are also available.

### Features

- High sound output 120dB (typical)
- Three alarm stages
- High output LED beacon
- Quarter turn fasteners for ease of installation
- First-fix, wire to base technology
- IP66 rated
- Volume control for greater flexibility - 20dB
- Low in-rush current
- Static/flashing mode
- 64 tones
- Separate connections for sounder & beacon

### Lens Colour Options



**Applications** - Conveyors, Process control alarm, Cranes, Moving machinery, Safety signalling

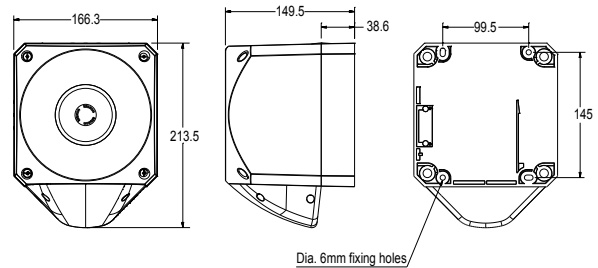

## Specifications

Part No.	Lens Colour	Beacon Type	Audibility at 1m	Tones	Voltage	Sounder Current	Beacon Current @24V
PNC-0211	Red Beacon	LED Beacon	Up to 120dB (A)	64	10-60V DC	120-550mA	55mA
PNC-0212	Amber Beacon	LED Beacon	Up to 120dB (A)	64	10-60V DC	120-550mA	55mA
PNC-0213	Clear Beacon	LED Beacon	Up to 120dB (A)	64	10-60V DC	120-550mA	55mA
PNC-0214	Blue Beacon	LED Beacon	Up to 120dB (A)	64	10-60V DC	120-550mA	55mA
PNC-0215	Green Beacon	LED Beacon	Up to 120dB (A)	64	10-60V DC	120-550mA	55mA

**IP Rating:** IP66    **Operating Temp:** -25°C to + 65°C    **Cable Entries:** 5  
**Weight:** 2kg    **Compliance:** EN54-3 Type B

# klaxon