

Nexus 110 Sounder Beacon (DC)

The Nexus 110 is a high output, low current consumption sounder beacon designed for fire and industrial applications. Connections are made to the base during the initial wiring phase which results in faster and more reliable installation. In addition, the head is fixed by quarter turn fasteners enabling faster installation and accurate seal compression for weatherproofing.

The combination of a powerful sounder and high output beacon ensures a very effective audio-visual signal. 105dB and 120dB units, as well as AC variants, are also available.

Features

- High sound output: 116dB (max); 110dB (typical)
- Three alarm stages
- High output LED beacon
- Quarter turn fasteners for ease of installation
- First-fix, wire to base technology
- IP66 rated
- Volume control for greater flexibility - 20dB
- Low in-rush current
- Static/flashing mode
- 64 tones
- Separate connections for sounder & beacon

Lens Colour Options



Applications - Conveyors, Process control alarm, Cranes, Moving machinery, Safety signalling

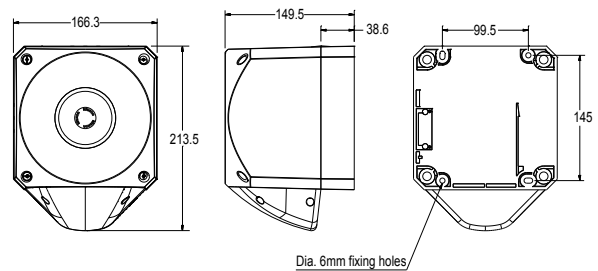

Specifications

Part No.	Lens Colour	Beacon Type	Audibility at 1m	Tones	Voltage	Sounder Current	Beacon Current @24V
PNC-0206	Red Beacon	LED Beacon	Up to 116dB (A)	64	10-60V DC	10-50mA	55mA
PNC-0207	Amber Beacon	LED Beacon	Up to 116dB (A)	64	10-60V DC	10-50mA	55mA
PNC-0208	Clear Beacon	LED Beacon	Up to 116dB (A)	64	10-60V DC	10-50mA	55mA
PNC-0209	Blue Beacon	LED Beacon	Up to 116dB (A)	64	10-60V DC	10-50mA	55mA
PNC-0210	Green Beacon	LED Beacon	Up to 116dB (A)	64	10-60V DC	10-50mA	55mA

IP Rating: IP66 Operating Temp: -25°C to +65°C Cable Entries: 5
Weight: 1.2kg Compliance: EN54-3 Type B

klaxon